

**THE COUNCIL OF THE CITY AND
COUNTY OF SWANSEA
CYNGOR DINAS A SIR ABERTAWE
TEMPORARY ROAD CLOSURE
VALE OF NEATH ROAD, PORT TENNANT, SWANSEA
NOTICE 2024**

NOTICE is hereby given that the Council of the City and County of Swansea in pursuance of its powers under the Road Traffic Regulation Act 1984 (as amended) intend to close the above-mentioned road.

In order for Alun Griffiths Contractors to undertake maintenance/installation works, it will be necessary to close the above-named road to vehicular traffic.

SCHEDULE 1 – TEMPORARY ROAD CLOSURE
VALE OF NEATH ROAD, PORT TENNANT, SWANSEA (PART)

Vale of Neath Road in an Easterly direction from its junction with Fabian Way for a distance of approximately 10 metres.

The alternative route for vehicular traffic will be via Fabian Way and Wern Terrace, a distance of approximately 100 metres.

Access for emergency vehicles to be maintained at all times.

The closure will operate from **Monday 22nd July 2024** for 5 days (Or until the works are completed whichever is the sooner). It is anticipated the works will take 5 days to complete.

Dated this 4th July 2024

TRACEY MEREDITH
CHIEF LEGAL OFFICER / PRIF SWYDDOG CYFREITHIOL
LEGAL & DEMOCRATIC SERVICES
GWASANAETHAU CYFREITHIOL A DEMOCRATAIDD
CIVIC CENTRE
CANOLFAN DDINESIG
SWANSEA
ABERTAWE
SA1 3SN

If you have any queries about this Notice please ring Dean Howard on 01792 841675

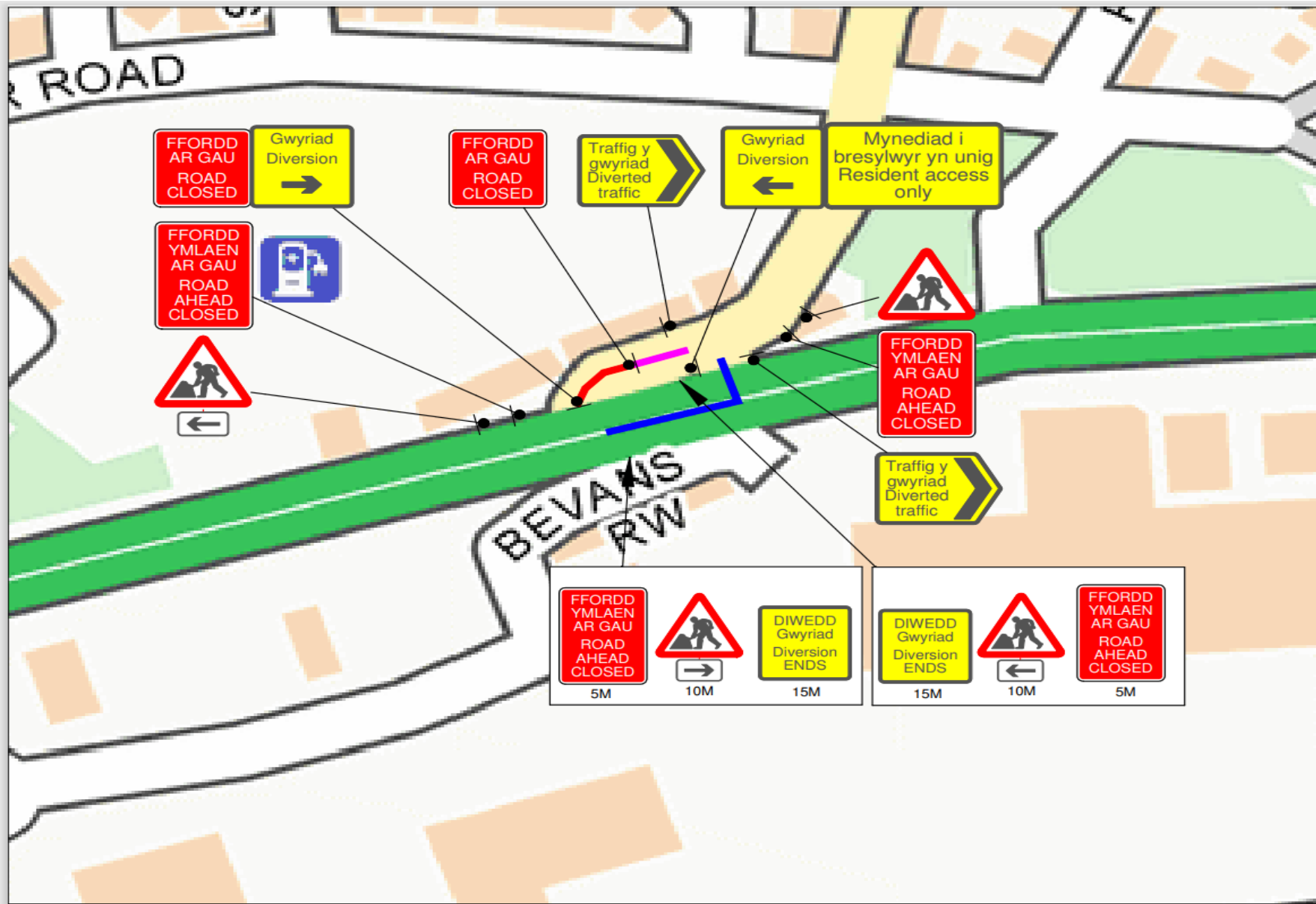

TRAFFIC MANAGEMENT NOTES

- 1) All temporary traffic management shall be in accordance with Chapter 8 of the Traffic Signs Manual.
- 2) All temporary traffic management shall be in accordance with the Traffic Signs Regulations and General Directions 2016.
- 3) All temporary traffic management shall conform to the Safety of Street Works and Road Works, A Code of Practice.
- 4) All signing should be located 450mm minimum from any carriageway.
- 5) All temporary traffic management sign locations are indicative and are subject to on site approval from the Engineer.

REF: 1	REF: 2024.1	
REF: 2	REF: 2024.2	
REF: 3	REF: 2024.3	
REF: 4	REF: 2024.4	
REF: 5	REF: 2024.5	
REF: 6	REF: 2024.6	
REF: 7	REF: 2024.7	
REF: 8	REF: 2024.8	
REF: 9	REF: 2024.9	
REF: 10	REF: 2024.10	
REF: 11	REF: 2024.11	
REF: 12	REF: 2024.12	

Key

- Traffic sign
- Traffic cone
- Pedestrian barrier
- Cone lamp
- Diversion route
- Road closure

Checked by: Sean Griffiths
 Customer: AGWW
 Job reference: N / A
 Location: Queens Dock Point, Swanssea Queens Dock, Swanssea SA1 8PA
 Date: 22/05/2024
 Description: Road Closure
 Scale: NTS OS HA: 0
 0330 043 3030
 www.corehighways.com
 Produced by: Darren Grave-Weir
 Design reference: DG/22.05.24/S120514
 All rights reserved. No part of this publication may be reproduced without the prior written permission of Core Highways.

core highways