

**SPECIAL EVENTS TRAFFIC ORDER
TEMPORARY (ROLLING) ROAD CLOSURES
1st CWMBWRLA BROWNIES, CHRISTMAS LANTERN PARADE 2024
NOTICE 2024**

THE COUNCIL OF THE CITY AND COUNTY OF SWANSEA in exercise of the powers conferred by Section 16A of the Road Traffic Act 1994, **HEREBY GIVE NOTICE** that on the various dates as shown in the Schedule below and as and when the appropriate traffic signs are displayed no person shall cause a vehicle (other than a vehicle being used for emergency purposes) to proceed along the length or lengths of road(s) referred to in the Schedule below.

SCHEDULE

1st Cwmbwrla Brownies are holding a Christmas Lantern Parade on **Monday 9th December 2024** which will start at 18:00hrs and end at approximately 19:00hrs.

As a result, it is considered necessary to temporarily close several roads (on a rolling basis) in the Manselton area from 17:15hrs to 19:00hrs:-.

Rolling Road Closures

Elgin Street
Brondeg Crescent
Brondeg
Walters Street
Manselton Road
Cae Rowlands
David Street
Pentregethin Road

Access for emergency vehicles and pedestrians to be maintained at all times.

Should you have any queries or require further information, please contact Dean Howard on 01792 841675.

Dated 18th November 2024

**TRACEY MEREDITH
CHIEF LEGAL OFFICER / PRIF SWYDDOG CYFREITHIOL
LEGAL, DEMOCRATIC SERVICES & BUSINESS INTELLIGENCE
GWASANAETHAU CYFREITHIOL, DEMOCRATAIDD A DEALLUSRWYDD BUSNES
CIVIC CENTRE
CANOLFAN DDINESIG
SWANSEA
ABERTAWE**

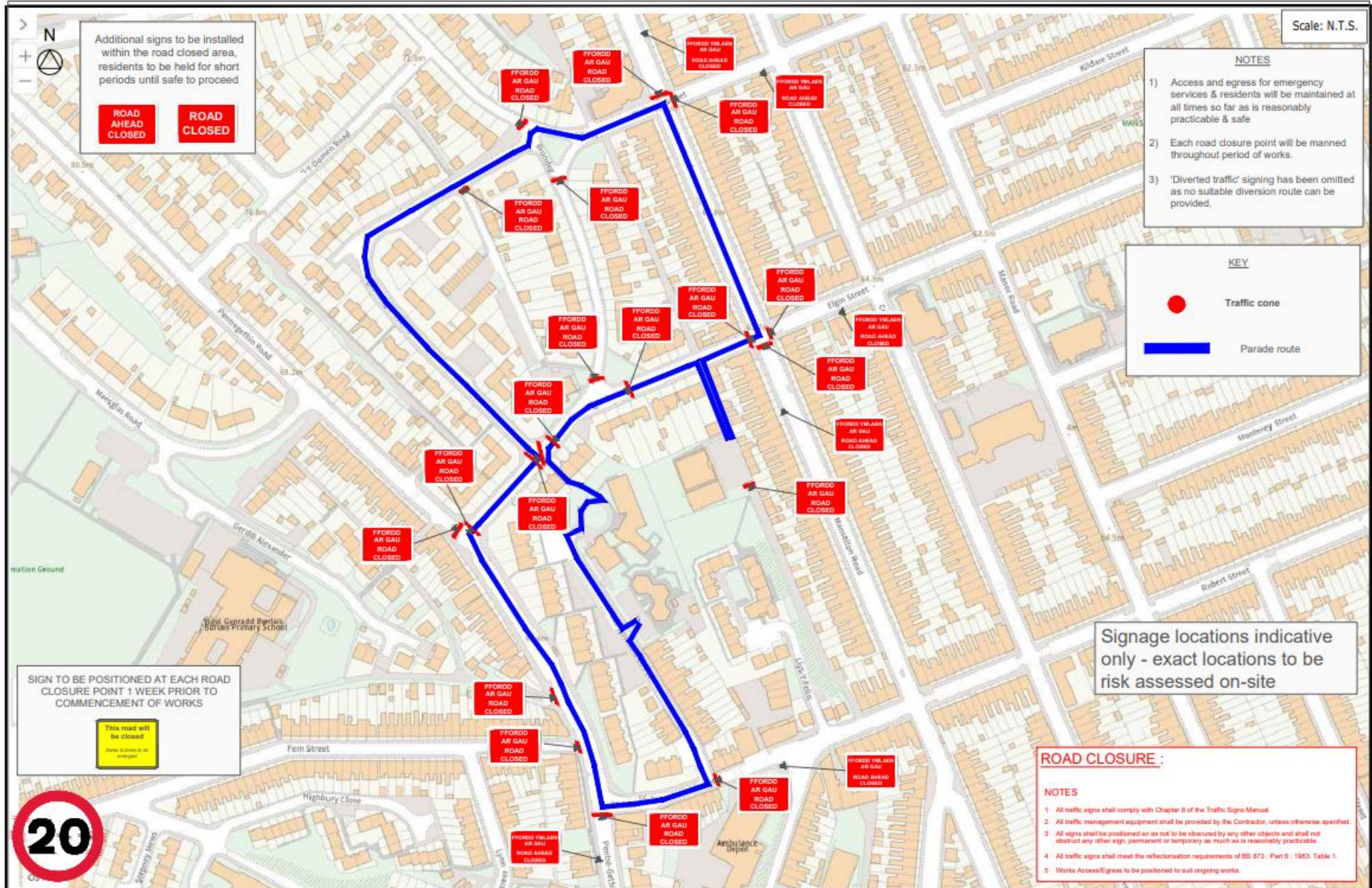

Additional signs to be installed within the road closed area, residents to be held for short periods until safe to proceed

ROAD AHEAD CLOSED **ROAD CLOSED**

- NOTES**
- 1) Access and egress for emergency services & residents will be maintained at all times so far as is reasonably practicable & safe
 - 2) Each road closure point will be manned throughout period of works.
 - 3) 'Diverted traffic' signing has been omitted as no suitable diversion route can be provided.

KEY

- Traffic cone
- Parade route

SIGN TO BE POSITIONED AT EACH ROAD CLOSURE POINT 1 WEEK PRIOR TO COMMENCEMENT OF WORKS

This road will be closed
From 08:00 to 18:00



Signage locations indicative only - exact locations to be risk assessed on-site

- ROAD CLOSURE :**
- NOTES**
1. All traffic signs shall comply with Chapter 6 of the Traffic Signs Manual
 2. All traffic management equipment shall be provided by the Contractor, unless otherwise specified.
 3. All signs shall be positioned so as not to be obscured by any other objects and shall not obstruct any other sign, permanent or temporary as much as is reasonably practicable.
 4. All traffic signs shall meet the reflectorisation requirements of BS 673 - Part 6, 1983, Table 1.
 5. Works Access/Signs to be positioned to suit ongoing works.

	Drn: MS	Client:	Project:	TM TYPE:	Ref: Cwmbwria Brownies- Lantern Parade- TMA01
	Chk: PF	Cwmbwria brownies	Lantern parade	Road closure in phases	Address: Elgin Street, Manselton, Cwmbwria, Swansea, Wales, SA5 8QQ, United
	REV: N/A				GRID REF - X 264960 , Y-195146
	Date: 11/11/24				