

**THE COUNCIL OF THE CITY AND
COUNTY OF SWANSEA
CYNGOR DINAS A SIR ABERTAW
TEMPORARY ROAD CLOSURE / A4067 PLASMARL BYPASS
CWM LEVEL ROAD TO MARTIN STREET, SWANSEA
NOTICE 2024**

NOTICE is hereby given that the Council of the City and County of Swansea in pursuance of its powers under the Road Traffic Regulation Act 1984 (as amended) intend to close the above-mentioned road. In order for Swansea Council to undertake highway maintenance and litter picking works at the above location, it will be necessary to temporarily close the above road to vehicular traffic.

**SCHEDULE
TEMPORARY ROAD CLOSURE / A4067 PLASMARL BYPASS
CWM LEVEL ROAD TO MARTIN STREET, SWANSEA**

SCHEDULE – TEMPORARY ROAD CLOSURE
A4067 CWM LEVEL ROAD TO MARTIN STREET, SWANSEA

The A4067 in a Northerly direction from its junction with Cwm Level Road to its junction with Martin Street, approximately 1.6 kilometres.

The alternative route for vehicular traffic will be via the B4603 – Neath Road, a distance of approximately 1.6 kilometres.

Access for emergency vehicles is to be maintained at all times.

The closure will operate from **Saturday 7th December 2024** for 5 days (Or until the works are completed whichever is the sooner). It is anticipated the works will take 2 days to complete (06:00-13:00).

Dated this 21st November 2024

**TRACEY MEREDITH
CHIEF LEGAL OFFICER / PRIF SWYDDOG CYFREITHIOL
LEGAL, DEMOCRATIC SERVICES & BUSINESS INTELLIGENCE
GWASANAETHAU CYFREITHIOL, DEMOCRATAIDD A DEALLUSRWYDD
BUSNES
CIVIC CENTRE
CANOLFAN DDINESIG
SWANSEA
ABERTAW
SA1 3SN**

If you have any queries about this Notice please ring Dean Howard on 01792 841675

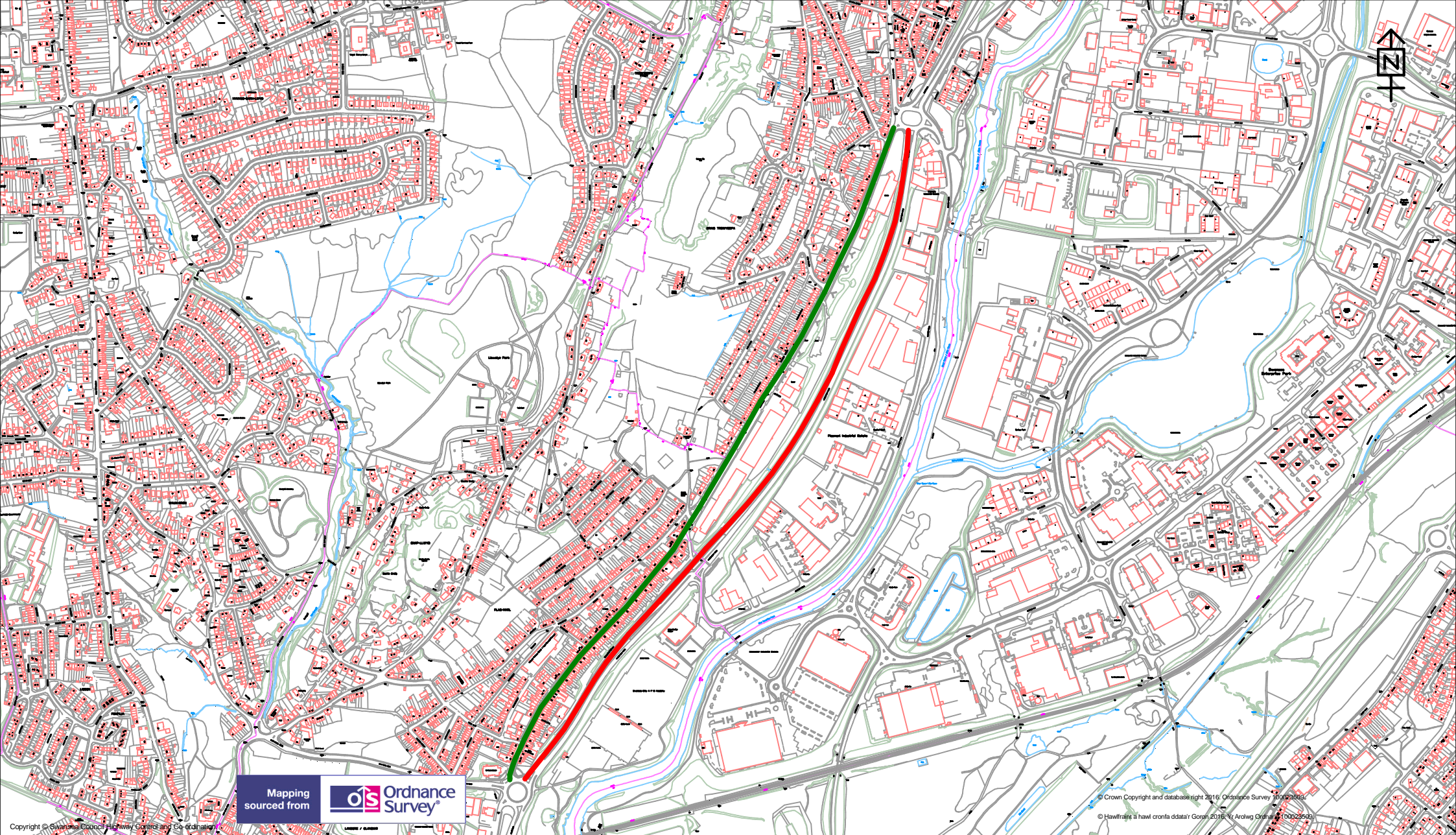

City & County of Swansea
Cinas A Sir Abertawe



TEMPORARY TRAFFIC REGULATION ORDER

Highways and Transportation

Mr Phil Roberts,
Director
City and County of Swansea,
Station Road, Players Industrial Estate,
Clydach, Swansea, SA6 5BJ

A4067 NORTHBOUND, CWM LEVEL ROAD TO MARTIN STREET.

KEY

Temporary Road Closure ■

Alternative Route ■

Scale
1:10216

Drawn DH	Checked DH
-------------	---------------

Revision A	Date 17/06/2016
---------------	--------------------

Dwg/Ref.No.
1911 - Phase 5