

**THE COUNCIL OF THE CITY AND COUNTY OF SWANSEA**  
**CYNGOR DINAS A SIR ABERTAWE**  
**PROPOSED TRAFFIC REGULATION ORDER**  
**A48 LLANGYFELACH ROAD, GORSEINON ROAD & PONTARDULAI ROAD**  
**PENLLERGAER WARD**  
**WAITING RESTRICTIONS AND CROSSINGS**  
**NOTICE 2025**

**NOTICE** is hereby given that the Council of the City and County of Swansea intends to make an Order in pursuance of its powers as contained in the Road Traffic Regulation Act 1984 (as amended) ("the Act") the effect of which is as set out in the Schedule(s) below. A copy of the proposed Order, Statement of Reasons and an appropriate plan may be inspected during normal office hours at the Civic Centre Oystermouth Road Swansea SA1 3SN. Any objections to the proposals should be submitted in writing setting out the reasons thereto to reach the undersigned at the above address or via E-mail at [Legal.TrafficNotices@swansea.gov.uk](mailto:Legal.TrafficNotices@swansea.gov.uk) by the 3<sup>rd</sup> November 2025 quoting reference DVT-284580/AVR.

**SCHEDULES**

**SCHEDULE 1**

**REVOCATIONS**

The existing Orders are revoked insofar as they are inconsistent with the proposals hereinafter contained which relate to the length or lengths of the road or roads referred to in the schedules hereto

**SCHEDULE 2**

**Prohibition of Waiting at Any Time (Red on plans T.25.SRIC.001-101)**

**A48 Llangyfelach Road**

Southern Kerb line

From its junction with the eastern kerbline of Old Llangyfelach Road in an easterly direction for 50 metres.

Northern Kerb line

From its junction with the eastern kerbline of Pontardulais Road in a easterly direction for 291 metres.

**Pontardulais Road**

East Kerb line

From its junction with the northern kerb line of Llangyfelach Road in a northerly direction for 86 metres.

**SCHEDULE 3**

**Provision of signal-controlled pedestrian crossings (Toucan crossings)**

**Llangyfelach Road**

At a point approximately 98 metres east of eastern kerbline of Pontardulais Road.

## **Gorseinon Road**

At a point approximately 154 metres west of western kerbline of Pheonix Way.

## **SCHEDULE 4**

### **Revocation of Pedestrian Crossing**

#### **Llangyfelach Road**

At a point approximately 72 metres east of eastern kerbline of Pontardulais Road.

#### **Gorseinon Road**

At a point approximately 232 metres west of western kerbline of Pheonix Way.

13<sup>th</sup> October 2025

**L A MOORE**

**CHIEF LEGAL OFFICER / PRIF SWYDDOG CYFREITHIOL**

**LEGAL & DEMOCRATIC SERVICES**

**GWASANAETHAU CYFREITHIOL A DEMOCRATAIDD**

## **STATEMENT OF REASONS**

### **Notice of Intent for the following Traffic Regulation Order**

**A48 LLANGYFELACH ROAD, GORSEINON ROAD,  
& PONTARDULAI ROAD**

**PENLLEGAER WARD**

The introduction of new 'Prohibition of Waiting at Anytime', new Pedestrian crossing Traffic Order are :-

- 1.) For facilitating the passage on the road or any other road of any class of traffic (including pedestrians).
- 2.) For avoiding danger to persons or other traffic using the road or any other road or for preventing the likelihood of any such danger arising.
- 3.) For preserving and improving the amenities of the area through which the road runs

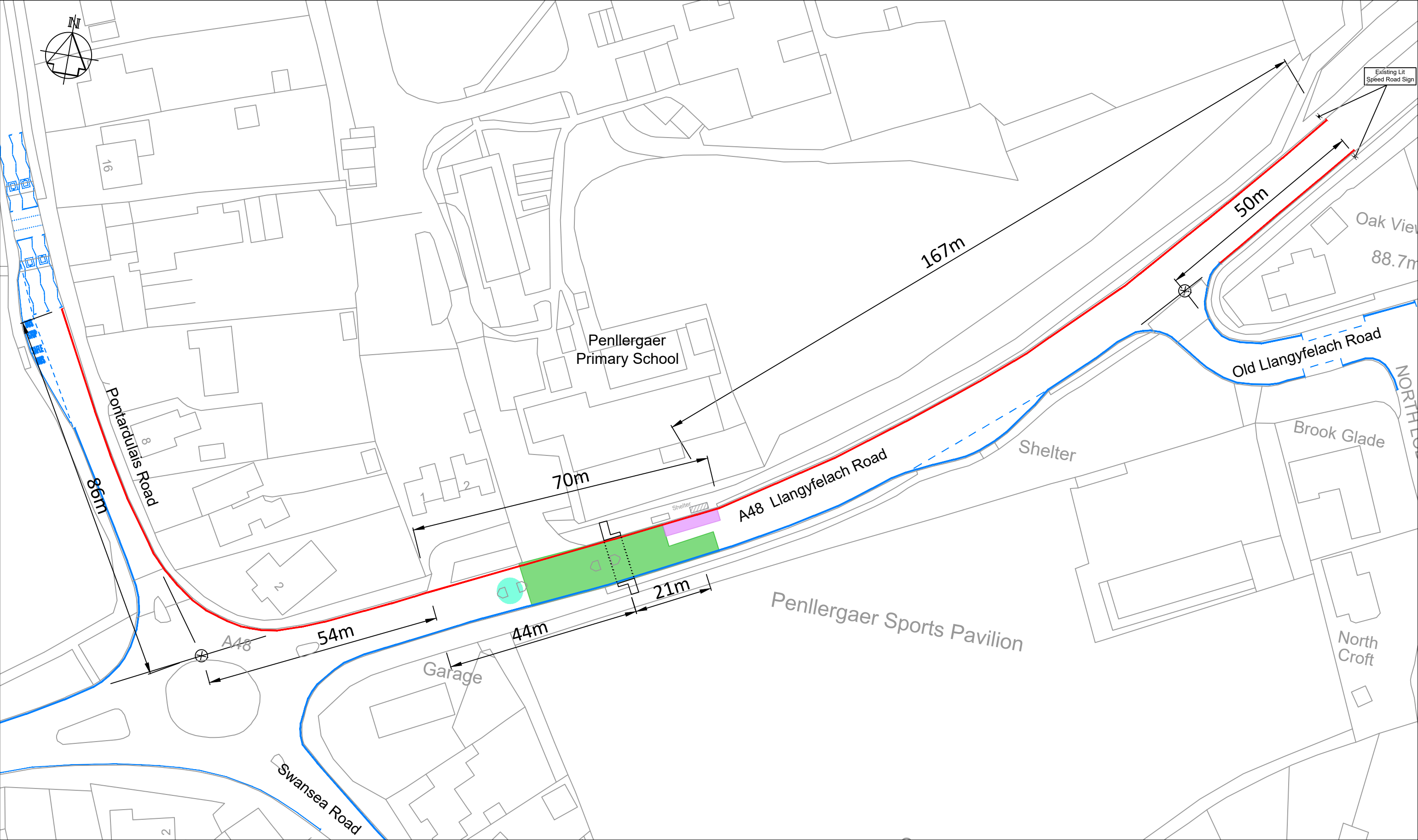

| Rev | Date | Details | Dr | Ch | Ap |
|-----|------|---------|----|----|----|
|     |      |         |    |    |    |

NOTES

- THIS IS A CAD DRAWING AND SHOULD NOT BE AMENDED BY HAND.
- All dimensions in millimetres unless otherwise stated.
- ©Hawlfraint y Goron a hawliau cronfa ddata 2025 Yr Arolwg Ordnans AC0000822618.  
©Crown Copyright and database rights 2025 Ordnance Survey AC0000822618.
- Any errors or omissions to be reported to the Designer.
- All existing Road Markings are to be made good where affected.

KEY

- Existing Traffic Regulation Order
- Proposed Prohibition of Waiting At Any Time Traffic Regulation Order (Double Yellow Lines)
- Proposed Toucan Crossing Location
- Relocated Bus Stop
- Location of Existing Toucan Crossing being removed

|                       |         |   |   |
|-----------------------|---------|---|---|
| A3                    |         | RHAGARWEINIOL - PRELIMINARY   |   |
| Dyluniwyd Drawn       | AJD     | Teil Title<br>Penllergaer Village<br>Safer Routes in our Communities<br>2025/26<br><br>Proposed Traffic Regulation Order<br><br>A48 Llangyfelach Road | <br>CYFARWYDDIAETH LLEOEDD<br>DIRECTORATE OF PLACE<br>STUART DAVIES - B Eng., C.Eng., M.I.C.E., MBA.<br>PENNAETH PRIFYRDOD A CHILIDANT<br>HEAD OF HIGHWAYS & TRANSPORTATION |
| Archwiliwyd Checked   | AJ      |   |   |
| Cymeradwywyd Approved | AF      |   |   |
| Dyddiad Date          | Jul '25 |   |   |
| Graddfa Scale         | NTS     | Rhif y Dyluniad Drawing No  | T.25.SRIC.001-101   |



| Rev | Date | Details | Dr | Ch | Ap |
|-----|------|---------|----|----|----|
|     |      |         |    |    |    |

**NOTES**

- THIS IS A CAD DRAWING AND SHOULD NOT BE AMENDED BY HAND.
- All dimensions in millimetres unless otherwise stated.
- ©Hawlfraint y Goron a hawliau cronfa ddata 2025 Yr Arolwg Ordnans AC0000822618.  
©Crown Copyright and database rights 2025 Ordnance Survey AC0000822618.
- Any errors or omissions to be reported to the Designer.
- All existing Road Markings are to be made good where affected.

**KEY**

- Existing Traffic Regulation Order
- Proposed Toucan Crossing Location
- Location of Existing Toucan Crossing being removed

|                       |                                    |  |   |
|-----------------------|------------------------------------|--|---|
| <b>A3</b>             | <b>RHAGARWEINIOL - PRELIMINARY</b> |  |   |
| Dyluniwyd Drawn       | AjD                                | Teil Title<br>Penllergaer Village<br>Safer Routes in our Communities<br>2025/26<br><br>Proposed Traffic Regulation Order<br><br>Gorseinon Road | <br><b>Cyngor Abertawe Swansea Council</b><br><br>CYFARWYDDIAETH LLEOEDD<br>DIRECTORATE OF PLACE<br>STUART DAVIES B Eng., C.Eng., M.I.C.E., MBA.<br>PENNAETH PRIFYRDOD A CHILIDANT<br>HEAD OF HIGHWAYS & TRANSPORTATION |
| Archwiliwyd Checked   | AJ                                 |  |   |
| Cymeradwywyd Approved | AF                                 |  |   |
| Dyddiad Date          | Jul '25                            |  |   |
| Graddfa Scale         | NTS                                | Rhif y Dyluniad Drawing No   | T.25.SRIC.001-102   |

**THE COUNCIL OF THE CITY  
AND COUNTY OF SWANSEA**

**CYNGOR DINAS A SIR ABERTAWE**



**TRAFFIC REGULATION ORDER  
A48 LLANGYFELACH ROAD, GORSEINON ROAD & PONTARDULAI ROAD  
PENLLERGAER WARD  
WAITING RESTRICTIONS AND CROSSINGS  
ORDER 2025**

**DVT-284580/AVR**

**THE COUNCIL OF THE CITY  
AND COUNTY OF SWANSEA  
CYNGOR DINAS A SIR ABERTAWE  
TRAFFIC REGULATION ORDER  
A48 LLANGYFELACH ROAD, GORSEINON ROAD & PONTARDULAI ROAD  
PENLLERGAER WARD  
WAITING RESTRICTIONS AND CROSSINGS  
ORDER 2025**

**THE COUNCIL OF THE CITY AND COUNTY OF SWANSEA** (hereinafter called “the Council”) in exercise of its powers under the Road Traffic Regulation Act 1984, as amended (hereinafter referred to as “the 1984 Act”), the Traffic Management Act 2004 (“the 2004 Act”), the Local Government (Miscellaneous Provisions) Act 1976 (“the 1976 Act”) and all other enabling powers, and after consultation with the Chief Officer of Police in accordance with Part III of Schedule 9 and Section 124 of the 1984 Act hereby makes the following Order.

**SECTION 1 – PRELIMINARY**

Citation and commencement

1. This Order shall come into operation on XX XXXXXX 2025 and may be cited as the Council of the City and County of Swansea, A48 Llangyfelach Road, Gorseinon Road & Pontardulais Road Penllergaer Ward (Waiting Restrictions and Crossings), Swansea Order 2025

Definitions

2. In this order, except where the context otherwise requires, the following expressions have the meaning hereby respectively assigned to them:

“Civil Enforcement Officer” has the same meaning as in Section 63A of the 1984 Act and by virtue of Section 76 of the 2004 Act a Civil Enforcement Officer appointed under Section 63A of the 1984 Act is a Civil Enforcement Officer in relation to parking contraventions;

“Disabled Person’s Vehicle” has the same meaning as in the Local Authorities’ Traffic Orders (Exemption for Disabled Persons) (Wales) Regulations 2000;

“Disabled Person’s Badge” has the same meaning as in the Disabled Persons (Badges for Motor Vehicles)(Wales) Regulation 2000;

“Parking Disc” means a disc and time clock (where appropriate) issued by a local authority complying with the requirements of the British Standard Specifications for Parking Discs to comply with the European Blue Badge Scheme being a disc coloured blue and capable of showing the quarter hour period during which a period of waiting begins;

“Relevant Position” in respect of:-

- (a) a Disabled Person’s Badge and parking disc has the same meaning as in the Local Authorities’ Traffic Orders (Exemptions for Disabled Persons) (Wales) Regulations 2000; and
- (b) a Waiver means exhibited on the windscreen, dashboard or fascia of the vehicle or, where the vehicle does not have a windscreen, dashboard or fascia, in a conspicuous position on the vehicle so that the whole of the information on the front of the waiver is clearly legible from outside the vehicle;

“Waiver” means a Waiver issued by the Council in respect of vehicles being used for building maintenance repair shop fitting or other industrial or demolition operations and the Council may charge for such waiver such charge to be determined from time to time by resolution of the Council or relevant Committee thereof;

### Interpretation

- 3. Except where otherwise stated, any reference in this Order to a numbered Article or Schedule is a reference to the Article or Schedule bearing that number in this Order
- 4. The Interpretation Act 1978 shall apply for the interpretation of this Order as it applies for the Interpretation of an Act of Parliament
- 5. The prohibitions and restrictions imposed by this Order shall be in addition to and not in derogation of any other prohibition or restriction whether made under the 1984 Act or otherwise

## **SECTION 2 – NO WAITING AT ANY TIME**

- 6. Save as provided in Articles 7 and 8 no person shall, except upon the direction or with the permission of a Civil Enforcement Officer, police officer in uniform, or a person



authorised by the Council, cause or permit any vehicle to wait at any time on the length or lengths of the road or roads referred to in Schedule 2 hereto.

#### Exemptions

7. Nothing in Article 6 of this Order shall render it unlawful to cause or permit any vehicle to wait on the side or sides or length or lengths of the road or roads specified therein for as long as may be necessary to enable:-

(a) the vehicle, if it cannot conveniently be used for such purpose in any other road, to be used in connection with any of the following operations namely:-

(i) building, maintenance, repair, shop fitting or other industrial or demolition operations with a Waiver issued by the Council and displayed in the Relevant Position on the windscreen of the vehicle;

(ii) the removal of any obstruction to traffic;

(iii) the laying, erection, alteration or repair in or on land adjacent to the said lengths or sides of the road of any sewer or any main pipe or apparatus for the supply of water, gas electricity or of any telecommunications apparatus as defined by the Telecommunications Act 1984; or

(iv) a vehicle being used for police, ambulance, fire brigade or other emergency purposes;

(b) the vehicle if it cannot conveniently be used for such purpose in any other road, to be used in connection with the service of a local authority or of a water authority in pursuance of its statutory powers and duties;

(c) the vehicle of the Royal Mail or other universal services provider as defined in Section 27 of the Postal Services Act 2011 to be used for the purpose of delivering or collecting mail; or

(d) vehicles picking up and dropping off passengers.

8. Nothing in Article 6 of this Order shall render it unlawful to cause or permit a Disabled Person's Vehicle which displays in the Relevant Position a Disabled Persons Badge and a Parking Disc (on which the driver, or other person in charge of the vehicle, has

marked the time at which the period of waiting began) to wait on lengths of sides of roads referred to in the Article for a period not exceeding 3 hours (not being a period separated by an

interval of less than 1 hour from the previous period of waiting by the same vehicle on the same length of side of road on which that vehicle had previously been waiting.

## **REVOCATION**

9. The existing Orders are revoked insofar as they are inconsistent with the proposals contained in the schedules hereto and insofar as they relate to the length or lengths of the road or roads referred to in the Schedule hereto.

## **SCHEDULES**

### **SCHEDULE 1**

#### **REVOCATIONS**

The existing Orders are revoked insofar as they are inconsistent with the proposals hereinafter contained which relate to the length or lengths of the road or roads referred to in the schedules hereto

### **SCHEDULE 2**

#### **Prohibition of Waiting at Any Time**

##### **A48 Llangyfelach Road**

Southern Kerb line

From its junction with the eastern kerbline of Old Llangyfelach Road in an easterly direction for 50 metres.

Northern Kerb line

From its junction with the eastern kerbline of Pontardulais Road in a easterly direction for 291 metres.

##### **Pontardulais Road**

East Kerb line

From its junction with the northern kerb line of Llangyfelach Road in a northerly direction for 86 metres.

Dated this

**THE COMMON SEAL OF THE** )  
**COUNCIL OF THE CITY AND** )  
**COUNTY OF SWANSEA** )  
was hereunto affixed )  
in the presence of )

Authorised Signatory

DRAFT